

T – Series
(Town Center)

TUE, SEP 09, 2008 07:17 A B.B 7-1 Z:\CLAYTON STANDARDS\DWG\2008 UPDATES\T-1-1 STREET LIGHT.DWG

HADCO GLOBE - VICTORIAN TOP (#RG 34ANNNN)

HADCO FIXTURE (S7582A)

ROUND FITTER WITH PETAL SCALLOPS

HAPCO 14' POLE (Y7S14B5-TFO) BLACK POWDER PAINT FINISH

120V INTERNAL OUTLET RECEPTACLE

* THIS DIMENSION SHALL BE 2.5' WHERE ELECTROLIERS ARE INSTALLED IN PLANTER AREAS.

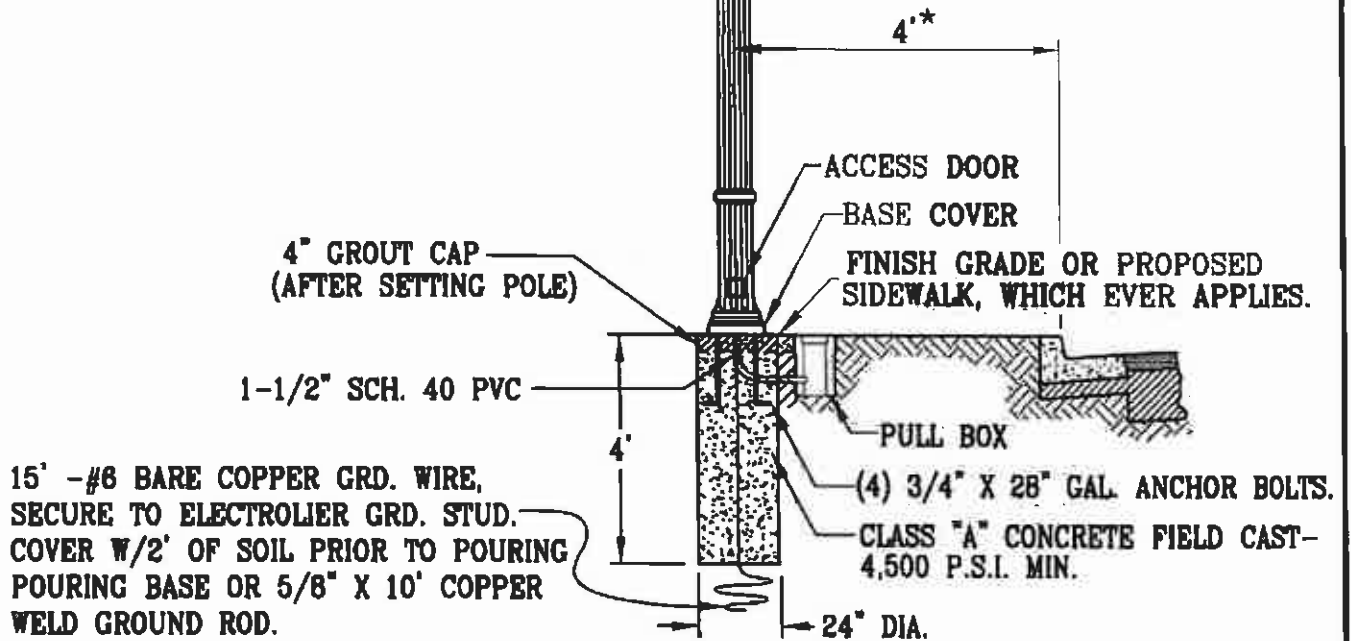

CITY OF CLAYTON
Founded 1857 ...Incorporated 1964

**ELECTROLIER DETAIL
 WITHIN TOWN CENTER AREA**

SHEET
 1 OF 1

DATE: AUGUST, 2008

SCALE: NONE

PAGE

APPROVED:

CITY ENGINEER

T-1

TUE, SEP 09, 2008 07:17 A B.B. T-2 Z:\CLAYTON STANDARDS\DWG\2008 UPDATES\T\T-2 TEXTURED CONCRETE.DWG

'BOARDWALK' PATTERN STAMPED CONCRETE, AS SHOWN. CONTRACTOR TO SUBMIT SAMPLE OF PATTERN, PRIOR TO CONSTRUCTION, FOR APPROVAL.

"BOMANITE" COLOR # A-31 "WALNUT" OR APPROVED EQUAL CONTRACTOR TO SUBMIT COLOR SAMPLE, PRIOR TO CONSTRUCTION, FOR APPROVAL.

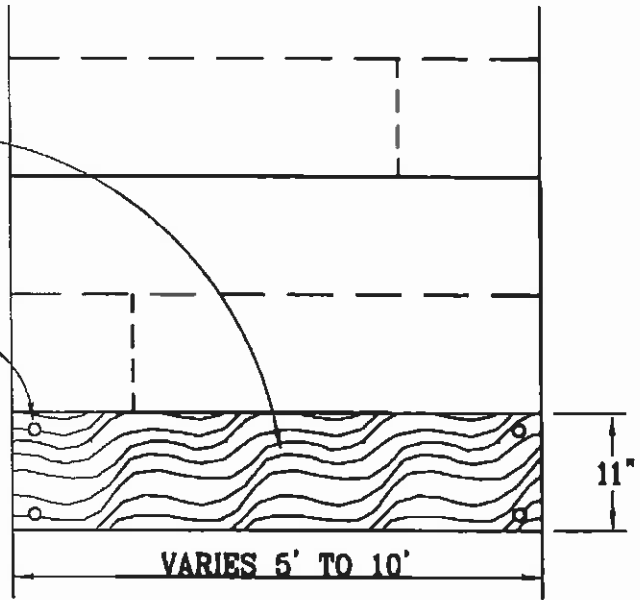

NOTE: SEE S-12 FOR JOINTS AND SCORELINES

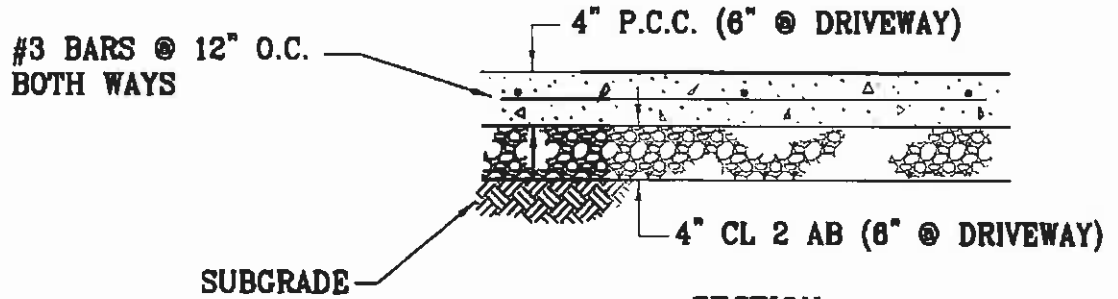

PLAN



SECTION

NOTE: SUBGRADE AND BASE ROCK TO BE COMPACTED TO 95%

SEE S-12 FOR WEAKENED PLANE JOINTS, SCORE LINES, AND CONSTRUCTION JOINTS.

 <p>CITY OF CLAYTON Founded 1857 ... Incorporated 1964</p>	TEXTURED CONCRETE SIDEWALK WITHIN TOWN CENTER AREA		SHEET 1 OF 1
	DATE: AUGUST, 2008	SCALE: NONE	PAGE
	APPROVED: 	CITY ENGINEER	T-2

TUE, SEP 09, 2008 07:19 A BJB T-3 Z:\CLAYTON STANDARDS\DWG\2008 UPDATES\1-3 RAISED PLANTER WALLS.DWG

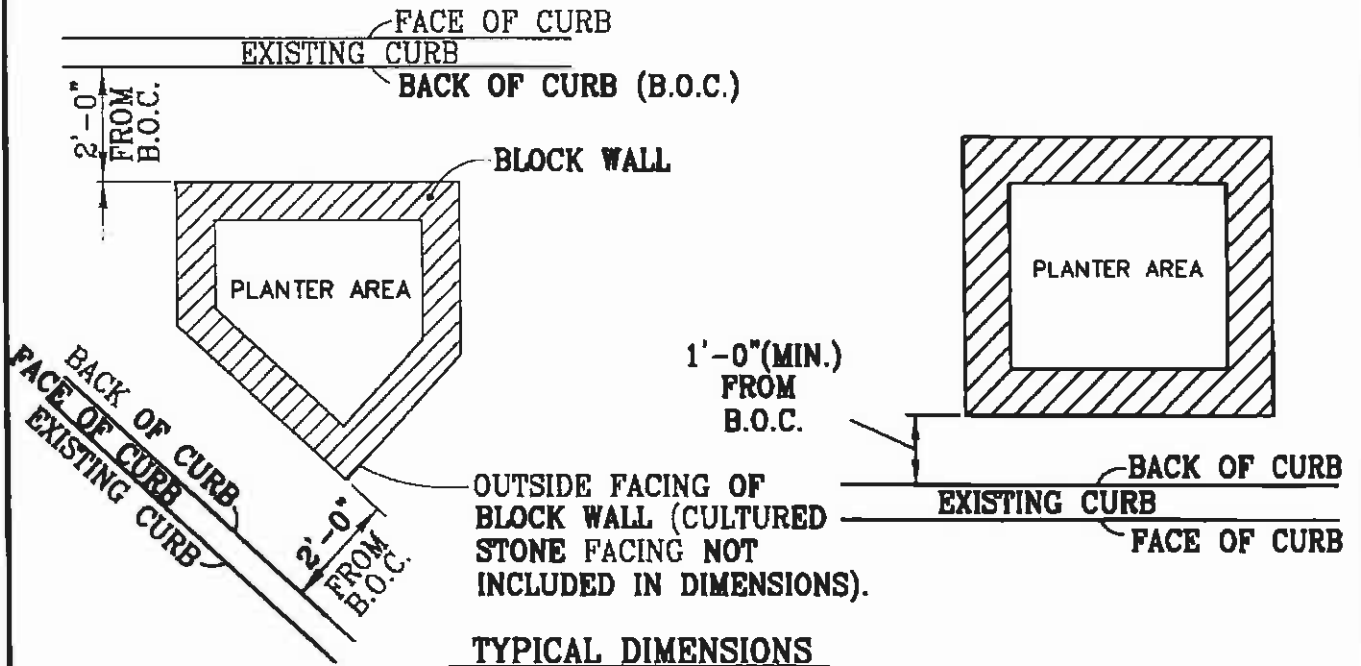
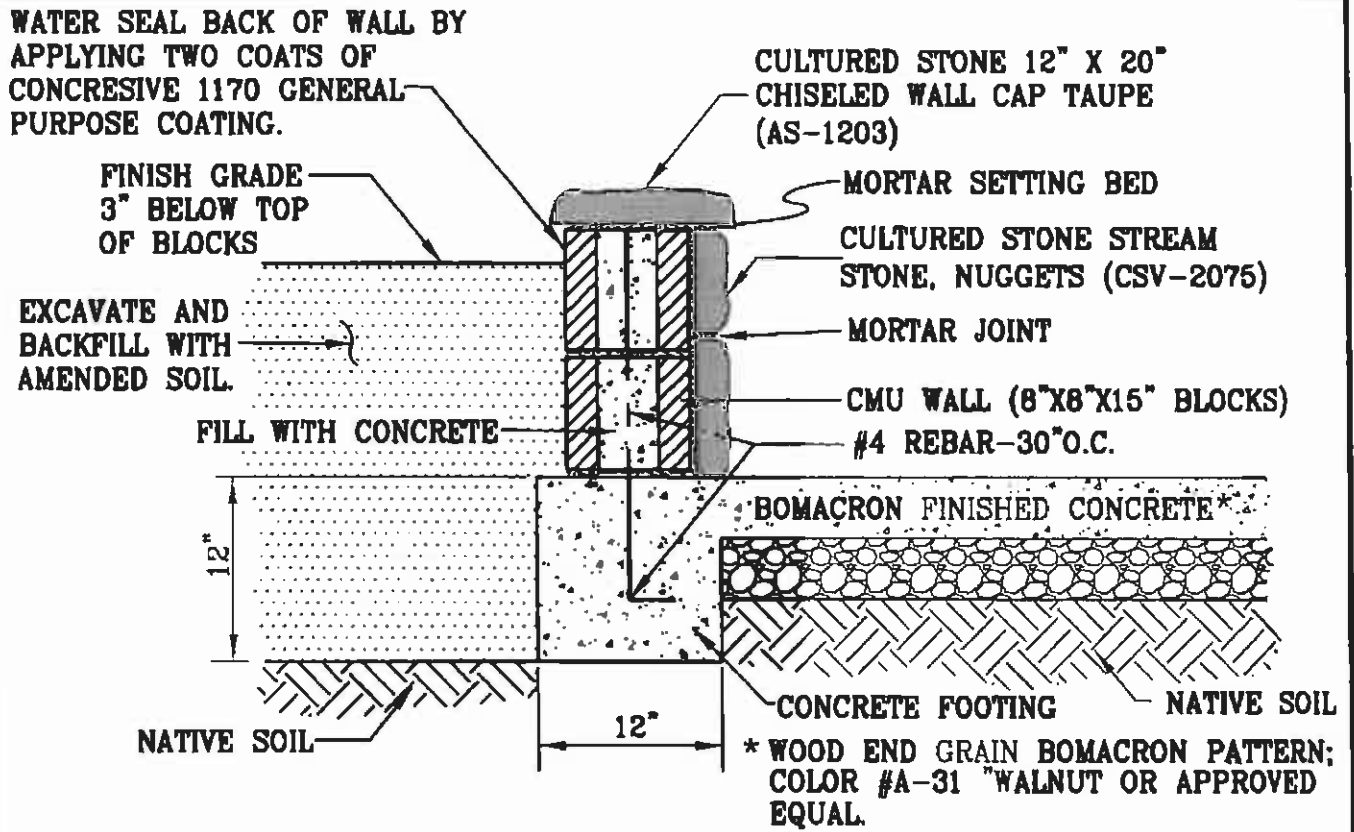

TYPICAL DIMENSIONS

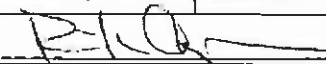
 <p>CITY OF CLAYTON Founded 1857 ...Incorporated 1964</p>	RAISED MASONRY PLANTER WALL WITHIN TOWN CENTER AREA		SHEET 1 OF 1
	DATE: AUGUST, 2008	SCALE: NONE	PAGE
	APPROVED:  CITY ENGINEER		T-3