

ADMINISTRATIVE USE PERMIT FOR FENCES

APPLICANT INFORMATION

Name _____

Address _____

Day Phone _____ Fax _____ Cell _____

PROPERTY OWNER INFORMATION (If Different Than Applicant)

Name _____

Address _____

Day Phone _____ Fax _____ Cell _____

SITE AND PROJECT INFORMATION

Address _____

Assessor's Parcel Number (provided by staff) _____

Zoning (provided by staff) _____

Reason Increased Fence Height is Needed _____

PROPERTY OWNER'S AND APPLICANT'S CONSENT AND VERIFICATION

I (We) consent to the submission of this application and declare, under penalty of perjury under the laws of the State of California, that the information in this application and its attachments is true and correct.

Property Owner's Signature _____ Date _____

Applicant's Signature _____ Date _____

STAFF USE ONLY		Date Stamp
Fee Amount	\$50	
Receipt Number	_____	
File Number	_____	
Staff Initials	_____	

SUBMITTAL REQUIREMENTS FOR ADMINISTRATIVE USE PERMIT FOR FENCES

Administrative Use Permits for seven-foot high fences must comply with Clayton Municipal Code regulations (Section 17.36.075.K) and any conditions of approval set by City staff.

APPLICATION ITEMS

- Complete application form.
- \$50 fee.
- Site Plan of the project site showing the following required information (minimum 8½ x 11 paper):
 - ▶ Scale or dimensions of all fences, property lines, etc.
 - ▶ North arrow with north at top of plan.
 - ▶ Property lines, adjacent properties, and adjacent streets.
 - ▶ Location, height, and materials of existing fencing.
 - ▶ Location, height, and materials of proposed fencing.
- Signature(s) of all adjacent property owners sharing the property line(s) where the seven-foot fence(s) is (are) proposed.

PROCESS

The Community Development Director may issue an administrative use permit to allow a fence up to seven (7) feet in height in a rear or side setback of a lot in a residential district. The Director may impose such conditions as deemed appropriate to mitigate any visual or other adverse impact of the fence, including but not limited to, requirements with respect to the height, design, and materials of the fence and any associated landscape screening.

Please answer the following questions:

Yes No

___ ___ Is the issuance of an Administrative Use Permit for a seven-foot fence necessary by due to unusual or special circumstances or conditions relating to the property, for the preservation of valuable property rights, or for the full use and enjoyment of the property?

___ ___ Will the fence create a safety hazard to pedestrians or vehicular traffic?

___ ___ Will the fence reasonably interfere with access by police, fire, and emergency service personnel?

___ ___ Will the appearance of the fence be compatible with the scale, mass, design, and appearance of other existing buildings and structures in the neighborhood?

___ ___ Will the orientation and location of the fence be properly related to the physical characteristics of the property and the neighborhood?

___ ___ Has written consent been obtained from the adjacent property owner(s)?

___ ___ Will the fence be of sound construction?

I hereby consent to a seven-foot fence height
(to be completed by property owner):

Signature _____

Name (print) _____

Address _____

I hereby consent to a seven-foot fence height
(to be completed by property owner):

Signature _____

Name (print) _____

Address _____

(to be completed by property owner):

Signature _____

Name (print) _____

Address _____

I hereby consent to a seven-foot fence height
(to be completed by property owner):

Signature _____

Name (print) _____

Address _____

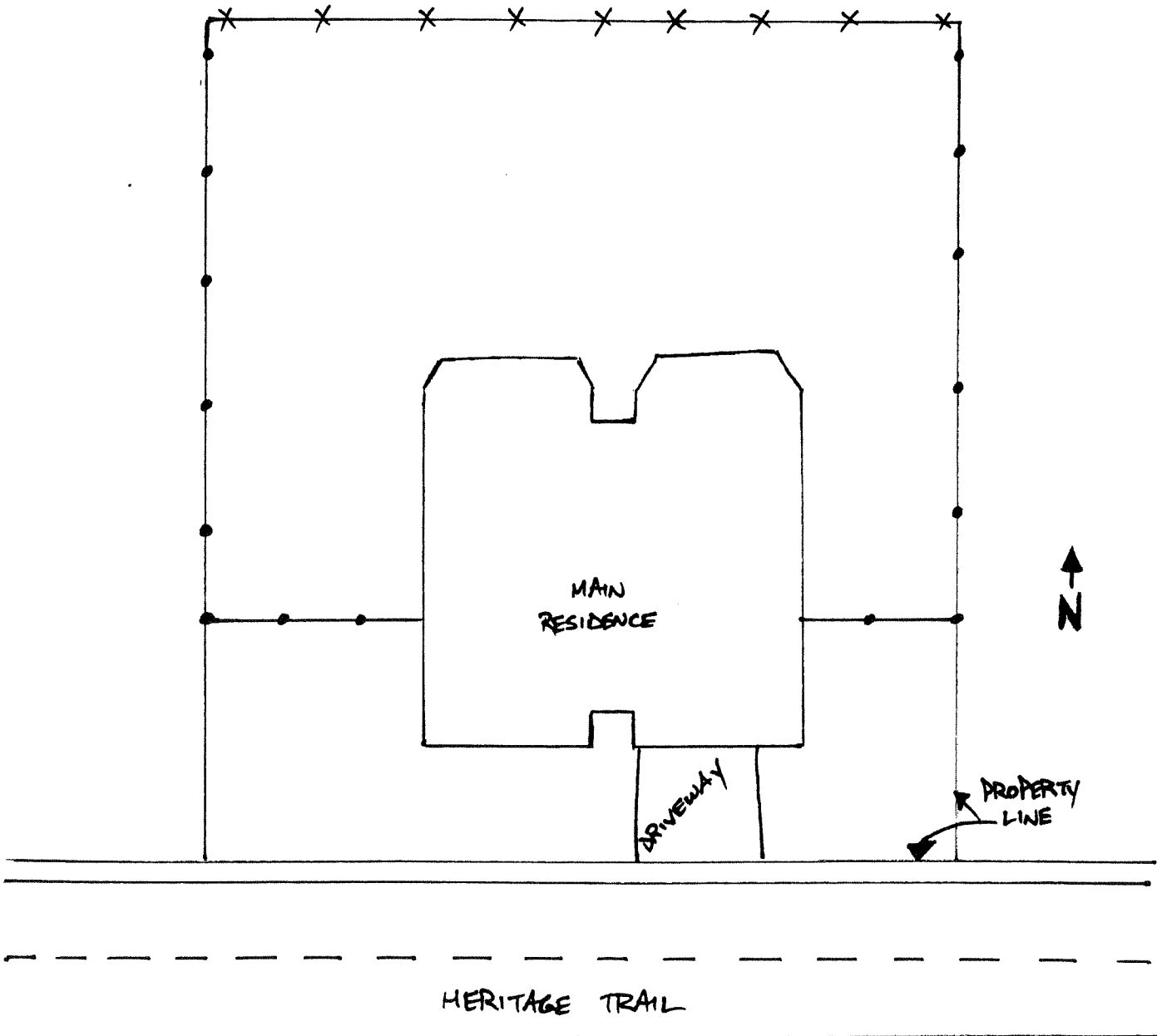

●●●●●● = 6' WOOD FENCE

×××× = 7' WOOD FENCE

